

PSL Self Tapping Screws Type 'B'



APPLICATION

Hex head self tapping screws Type 'B' are used to fasten steel or aluminium profiles to steel thickness over 3.0mm.

Available in Stainless Steel Grade 304/316 and Carbon Steel with RUSPERT/TUFCOTE coating.

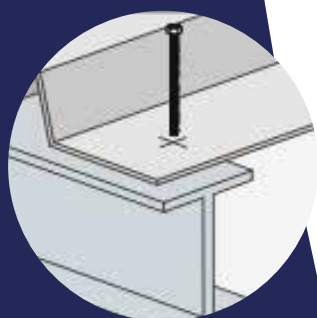
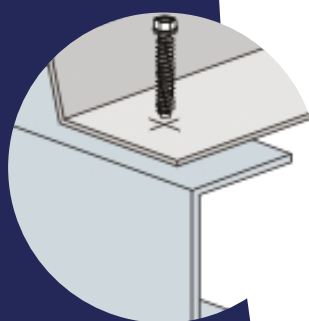

Thread dia : #14 (6.10-6.3mm)

Thread type : Fine ("B") with flute and flat end

Length : 1" - 9" (25mm - 225mm)

Recommended drill bit diameters*

Metal thickness	Drill bit dia
2.0-4.0mm	5.3mm
4.0-7.0mm	5.5mm
Above 7.0mm	5.7mm

* *drill holes depends on the hardness of the steel, therefore a site test prior to installation is recommended*

Recommended drive speed

Stainless Steel Screw : 600 - 800 RPM
Carbon Steel Screw : 1800 - 2000 RPM

Washer : 16mm and 19mm bonded to EPDM seal.