

Threaded Studs

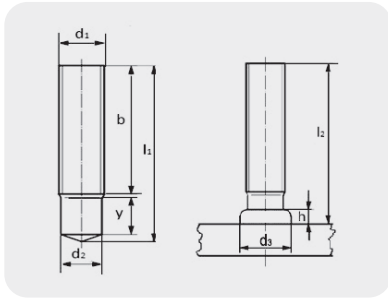

Threaded studs are manufactured according to ISO 13918 & are supplied with ferrules.

PD type

Material : 4.8 ,A2 ,A4.

Dimensions of threaded studs (PD)

<i>d1</i>	<i>l2</i>	<i>b</i>	<i>d2</i>	<i>d3</i>	<i>h</i>
<i>M8</i>	55	40	7.19	10	3.5
	65				
	70				
	80				
	90				
	100				
<i>M10</i>	55	40	9.03	12.5	4
	65				
	70				
	80				
	100				
	120				
	150				
	200				
<i>M12</i>	55	40	10.86	15.5	4.5
	65				
	70				
	80				
	100				
	120				
	150				
	160				
<i>M16</i>	55	40	14.6	19.5	6
	65				
	70				
	80				
	100				
	120				
	150				
	160				
<i>M20</i>	35	19.5	18.38	24.5	7
	40	24.5			
	45	29.5			
	50	34.5			
	55	39.5			
	65	40			
	70				
	80				
	100				
	120				
	150				
	200				
	<i>M24</i>				
65					
70					
80					
100					
120					
150					
200					

- Other dimensions are available upon request
- Dimensions in mm

RD type (Threaded stud with reduced shaft)

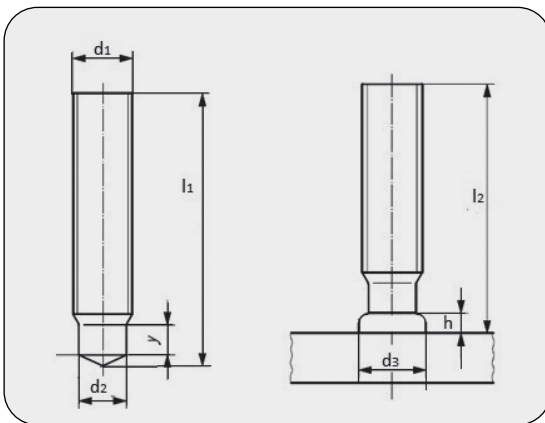

Material : 4.8 ,A2 ,A4.

Dimensions of threaded studs with reduced shaft for $15\text{mm} \leq L_2 \leq 100\text{mm}$

<i>d1</i>	<i>M6</i>	<i>M8</i>	<i>M10</i>	<i>M12</i>	<i>M16</i>	<i>M20</i>	<i>M24</i>
<i>d2</i>	4.7	6.2	7.9	9.5	13.2	16.5	20
<i>d3</i>	7	9	11.5	13.5	18	23	28
<i>h</i>	2.5	2.5	3	4	5	6	7
<i>y</i>	4	4	5	6	7.5 / 11 ^a	9 / 13 ^a	12 / 15 ^a
<i>l1</i> ± 1	<i>l1</i> ± 2.0	<i>l1</i> ± 2.2	<i>l1</i> ± 2.4	<i>l1</i> ± 2.8	<i>l1</i> ± 3.6	<i>l1</i> ± 3.9	<i>l1</i> ± 4.7

UD Type (Unthreaded stud)

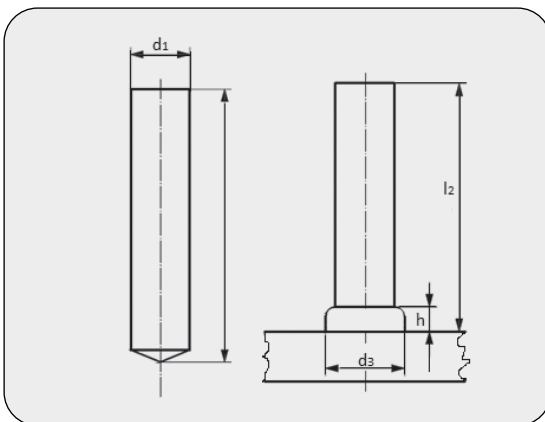

Material : 4.8 ,A2 ,A4.

Dimensions of unthreaded studs (UD) for $l_2 \geq 20\text{mm}$

<i>d1</i>	6	8	10	12	14.6	16
<i>d3</i>	8.5	11	13	16	18.5	21
<i>h</i>	4	4	4	5	6	7
<i>l1</i> ± 1	<i>l1</i> ± 2.4	<i>l1</i> ± 2.6	<i>l1</i> ± 2.8	<i>l1</i> ± 3.4	<i>l1</i> ± 3.9	<i>l1</i> ± 3.9

- Other dimensions are available upon request
- Dimensions in mm

For threaded studs, pins, and similar products, mechanical properties are according to ISO 898-1, property class 4.8